



FULDA 3in1 Mono eHPoca

Heat pumps



**Taking free heat
from nature to
warm up your home.**



eHPoca

Heat pumps





FULDA M1

Heat pumps





3in1 Mono SV

Heat pumps





The versions



FULDA M1 **New 2025**

Packaged heat pump complete with pump, safety valve.



Suitable for:



Offices



Apartments



Small, medium and large sized homes



FULDA H1 **New 2025**

Indoor tower unit with built-in 200-liter storage tank for instantaneous DHW production and connected to the outdoor unit through hydraulic lines.



Suitable for:



Small and medium-sized homes



Apartments





3in1 Mono

Ducted monobloc air/water heat pump composed of heat pump unit and 200 litre DHW module.

Standard heating element 2 kW.

Unit complete with: primary circulation pump and DHW diverter valve.

Without outdoor unit.

Suitable for:



Small and
medium-sized
homes



Apartments



eHPoca

Internal hydraulic module with circulation pump and heat exchanger connected to the outdoor unit via refrigerant pipes. Flexible solution suitable for implementation of tailor-made systems.

Indicato per:



Offices



Centralised
systems



Medium and
large-sized
homes

FULDA M1



REFRIGERANT R290



REMOTE CONTROL VIA APP



DC INVERTER

Maximum comfort with the lowest consumption and quietest operation.



HIGHEST ENERGY CLASS



The heat pump monoblock R290



Refrigerante a basso
GWP

FULDA is the latest generation of packaged Air/Water heat pump, designed to meet the needs of heating, cooling and domestic hot water production in residential and tertiary sectors. It uses the environmentally friendly refrigerant R290, known for its low environmental impact and high energy efficiency, ensuring optimal performance even at low outdoor temperatures. With its compact design and state-of-the-art technology, FULDA is an ideal solution for those seeking comfort, sustainability and reduced energy consumption, fitting perfectly with both new construction and renovation projects.

DISPLAY TOUCH CONTROL INTERFACE

Settings and display: through the built-in 10" touch screen display.

Accessory to be purchased separately.

All electrical connections are located in the electrical panel on board the outdoor unit.

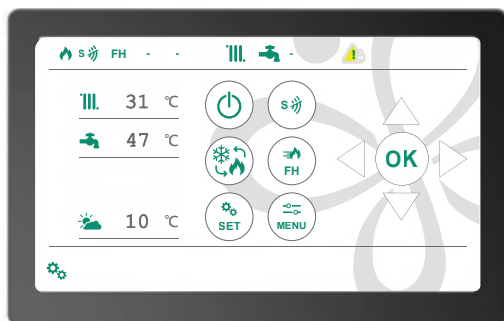

WATERFALL MANAGEMENT KIT

The cascade management kit is an electronic control device designed to efficiently manage multiple heat pumps connected in a cascade configuration.

The cascade management kit is equipped with a display and can be connected from 2 to 16 units.

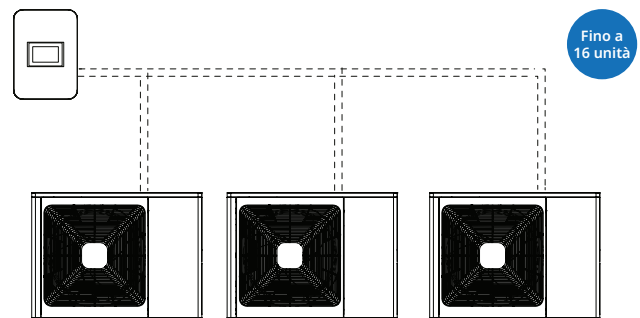

Installation components

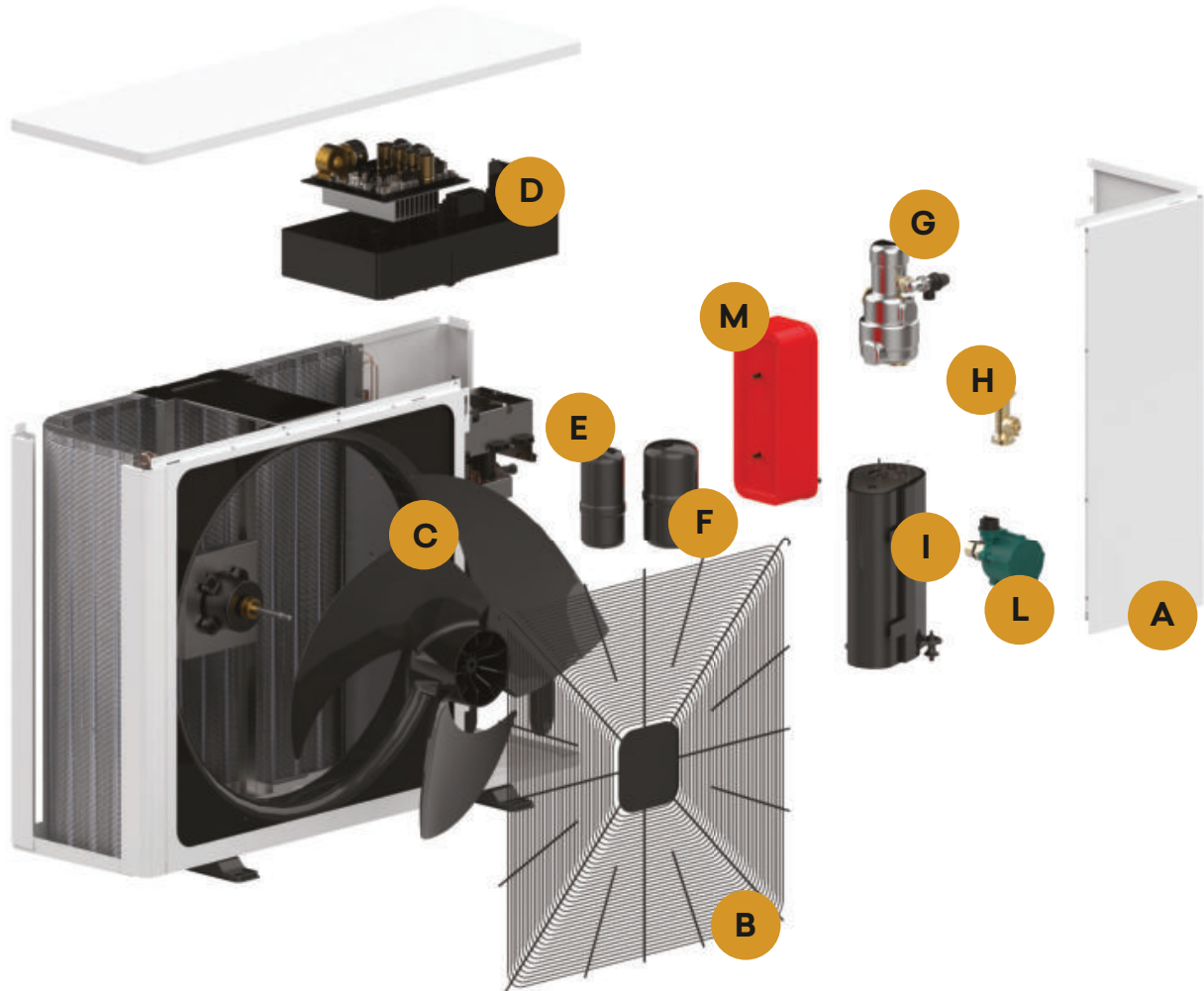

STANDARD COMPONENTS

- A. RAL9003 structure and panels
- B. Delivery grid
- C. Fan
- D. Electrical cabinet
- E. Liquid separator

- F. Liquid receiver
- G. Degasser
- H. Vortex flow transducer
- I. Compressor
- L. Circulator
- M. Plate heat exchanger



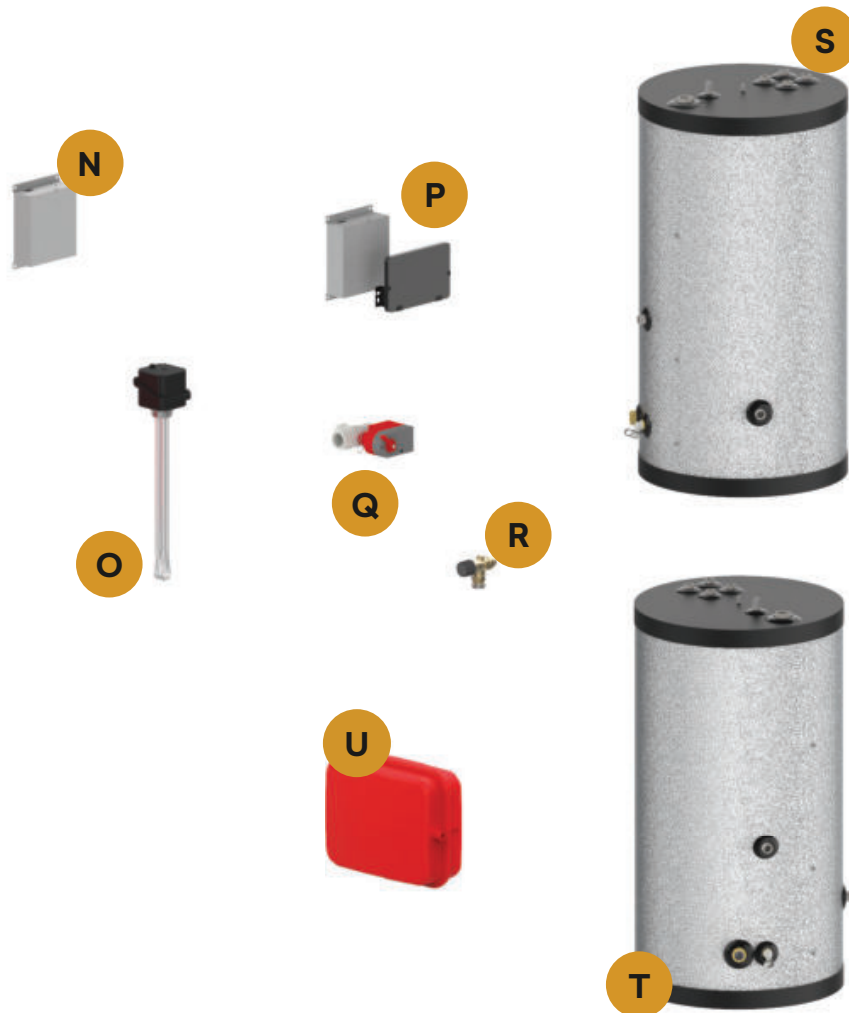

ACCESSORY KITS (SUPPLIED SEPARATELY)

N. BUTLER PRO (installed in the electrical panel)

O. Heating resistors (on outdoor unit):

for heat pumps 5 M - 7 M: 3 kW (2+1 kW selectable in steps);

for heat pumps 9 M/T - 12 M/T - 15 M/T: 6 kW (2+2+2 kW selectable in steps)

P. BUTLER PRO TOUCH

Q. ACS 3-way valve

R. Antifreeze safety valve

S. ACS inertial tank

T. Inertial storage

U. Plant-side expansion tank (accessory not supplied by INNOVA)

FULDA H1



SMALL FOOTPRINT SPACE

All plant behaviors are integrated into the internal module.



DC INVERTER

Maximum comfort with the lowest consumption and quietest operation.

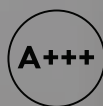

HIGHEST ENERGY CLASS

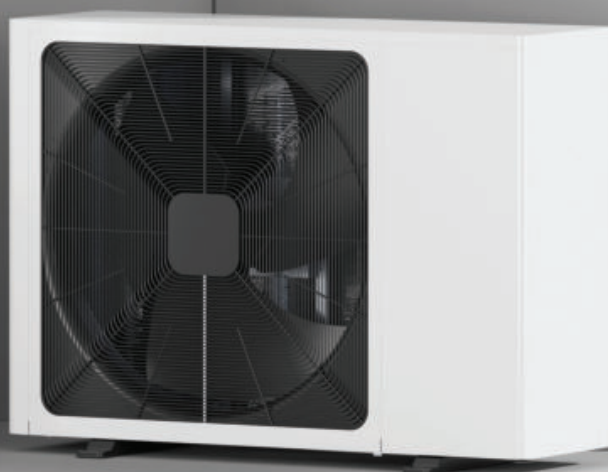

COLLEGAMENTI
IDRONICI

Hydronic connection between outdoor unit and indoor unit



Refrigerante a basso
GWP

FULDA H1 is the monoblock heat pump Air-to-water, complete with indoor unit with integrated domestic hot water storage and connected to the outdoor unit through lines hydraulic lines.

EASY TO INSTALL

Visible tower indoor unit with integrated domestic hot water storage and connected to the outdoor unit through hydraulic lines. Complete solution that provides reliability and small footprint and does not require connection of refrigerant lines. Complete with touch display control interface.

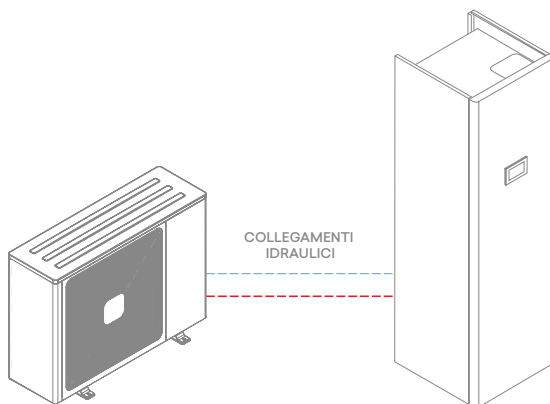

WATERFALL MANAGEMENT KIT

The cascade management kit is an electronic control device designed to efficiently manage multiple heat pumps connected in a cascade configuration.

The cascade management kit is equipped with a display and can be connected from 2 to 16 units.

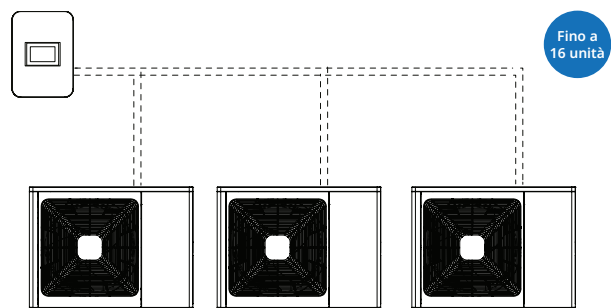

The whole plant in 60x60 cm

- reduction of overall dimensions
- delivery of the unit with all components already installed and tested

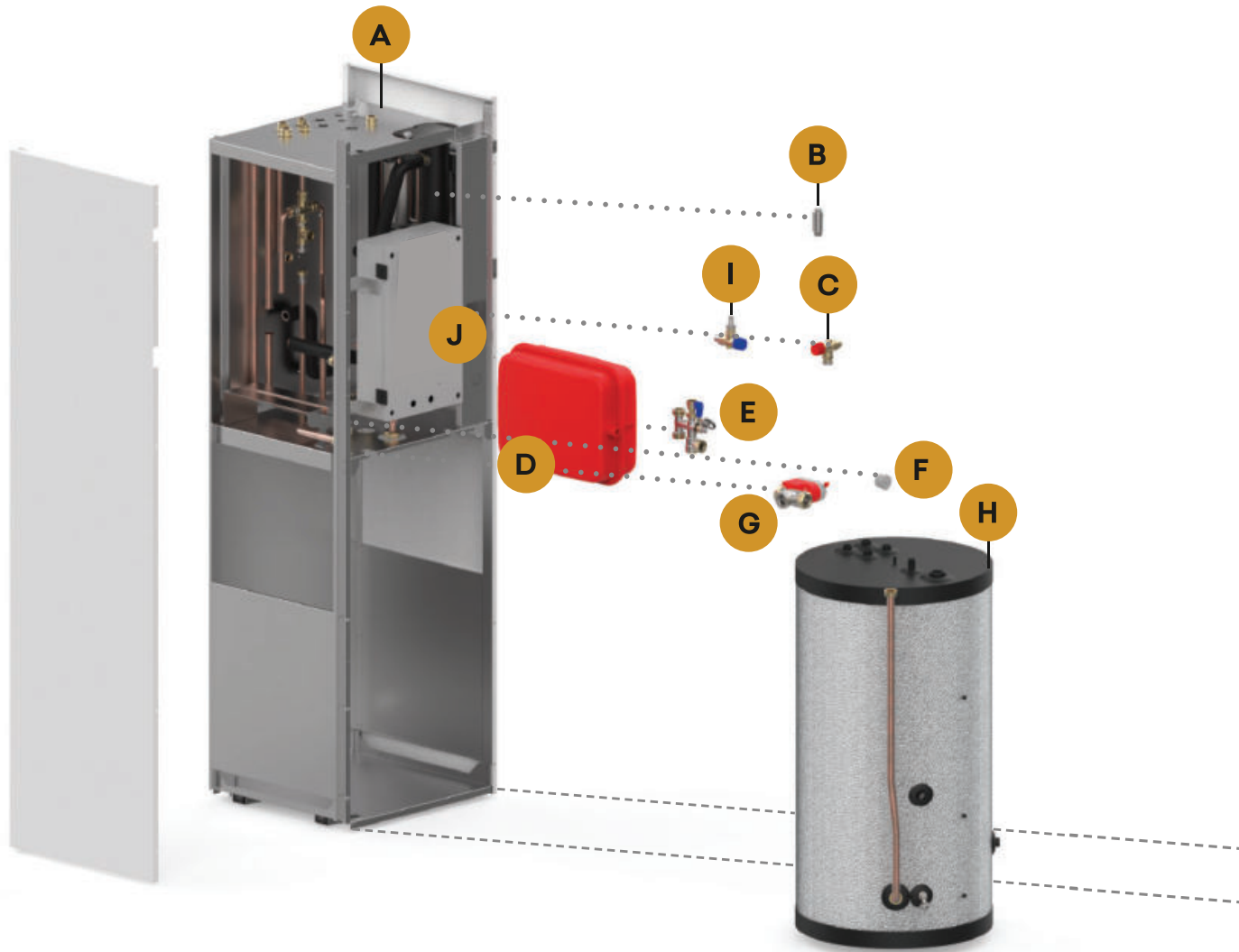

STANDARD COMPONENTS

- A. RAL9003 structure and cover panels with control interface display
- B. Automatic vent valve
- C. System safety valve 3 bar
- D. Plant expansion tank 24 liters
- E. Plant loading unit and Y filter
- F. Pressure gauge
- G. ACS system 3-way valve
- H. Domestic hot water preparation storage tank 200 liters instantaneous type, standard without solar coil
- I. Domestic hot water safety valve 7 bar
- J. Electrical panel



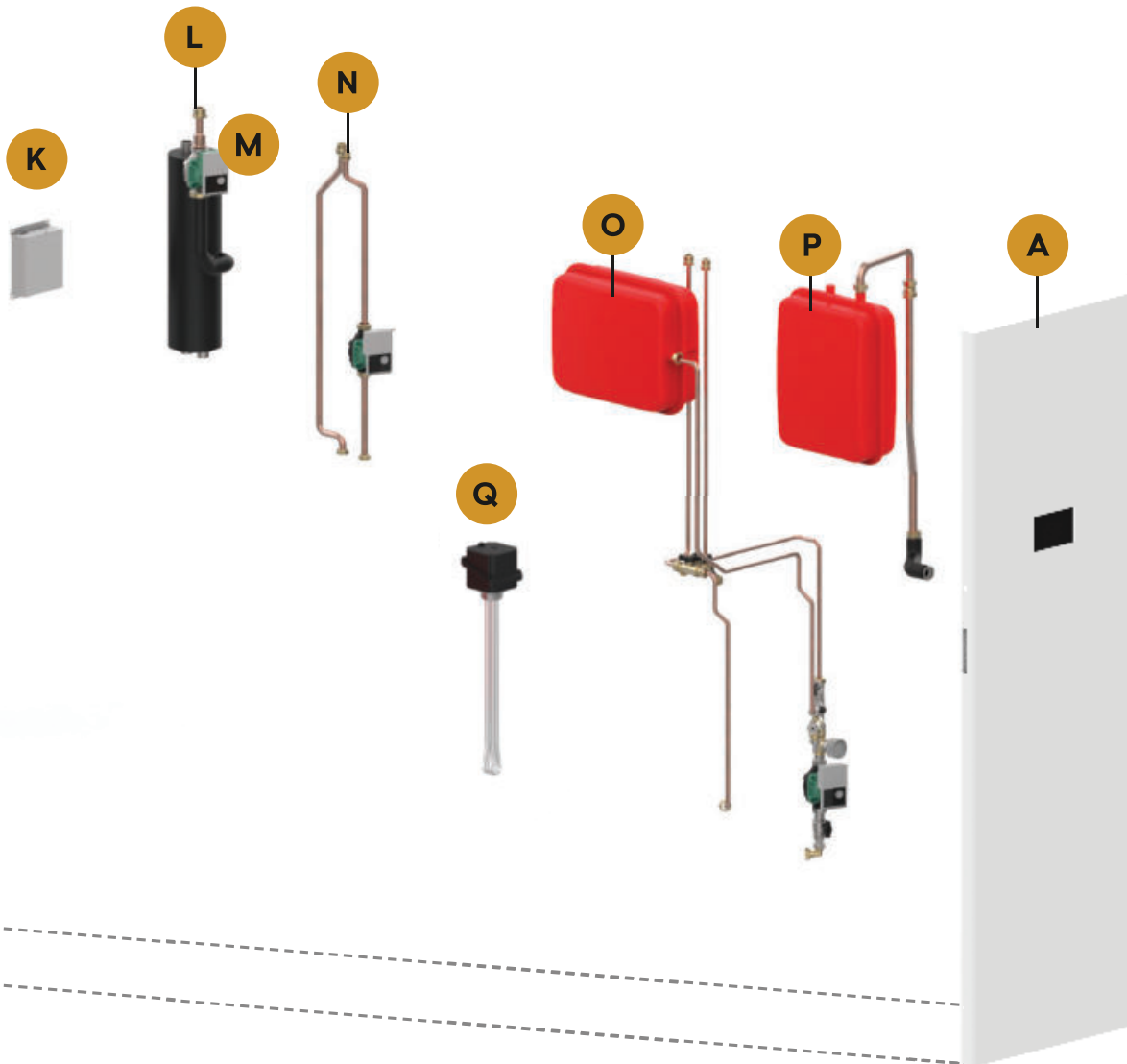

SUPPLIED ACCESSORY KITS INSTALLED IN THE UNIT

K. BUTLER PRO

L. Separator kit with secondary pump for 5-7 kW units (mandatory)

M. Separator kit with secondary pump for 5-15 kW unit (mandatory)

N. Thermobath kit

O. Solar kit (can be used if inertial tank kit accessory is not present): control unit, pump, safety valve, 24-liter expansion tank, loading unit, system filling tap, domestic hot water thermostatic mixer, and storage tank with solar coil

P. Inertial tank kit 20 liters (as an alternative to the solar kit)

Q. Heating elements (on outdoor unit):

for heat pumps 5 M - 7 M: 3 kW (2+1 kW selectable in steps);

for heat pumps 9 M/T - 12 M/T - 15 M/T: 6 kW (2+2+2 kW selectable in steps)

3in1 Mono



DC INVERTER

Maximum comfort with the lowest consumption and quietest operation.



REFRIGERANT R32

Refrigerant with low environmental impact

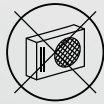

WITHOUT OUTDOOR UNIT

The outdoor unit is replaced by 2 grills



APP

Remote control via App



The heat pump without an outdoor unit

3in1 Mono is the air/water heat pump without an outdoor unit, designed for all those situations where there is no space available for housing the outdoor unit, e.g. apartments without balconies or with limited terraces.

S

Single version

Single heat pump module (without tank).



SH

Version with horizontal combination

Heat pump module plus DHW module with horizontal combination.



SV

Version with vertical combination

Heat pump module plus DHW module with vertical combination.



3in1 Mono installation

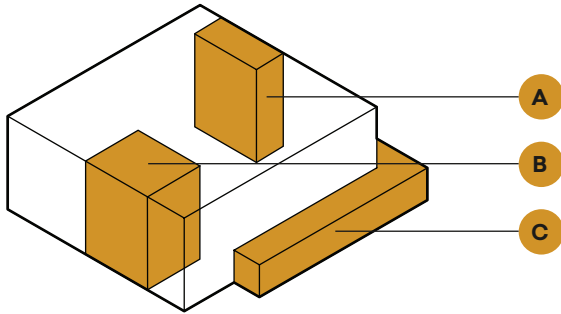

- A. Landing access to apartment
- B. Laundry
- C. Terrace / Balcony

3in1 Mono is the compact and complete indoor solution that includes the functionality of the outdoor unit.

All elements of the system are contained within the cabinet ensuring a reduced footprint and increased reliability as everything is installed, adjusted and tested at the factory.



Small and medium-sized homes



Apartments

The components of the outdoor unit are incorporated in the indoor unit and communication with the outside environment is via fittings provided in the catalogue. On the outside, only two grills are visible. On the inside, however, it remains a compact and elegant unit with the same floor plan dimensions as an appliance.

No outdoor unit, only two grills

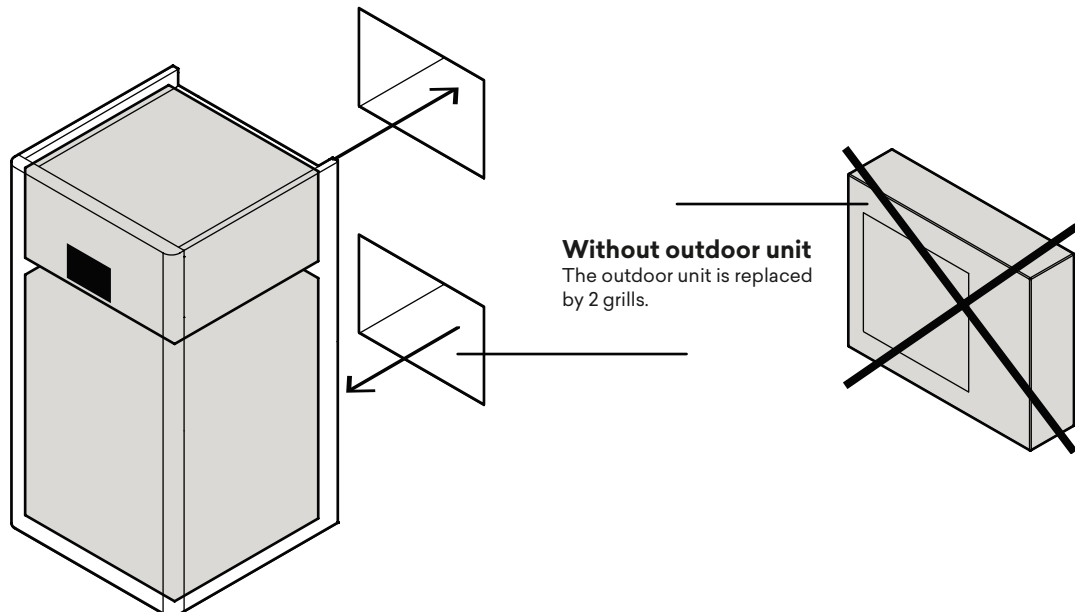

3in1 Mono system diagram

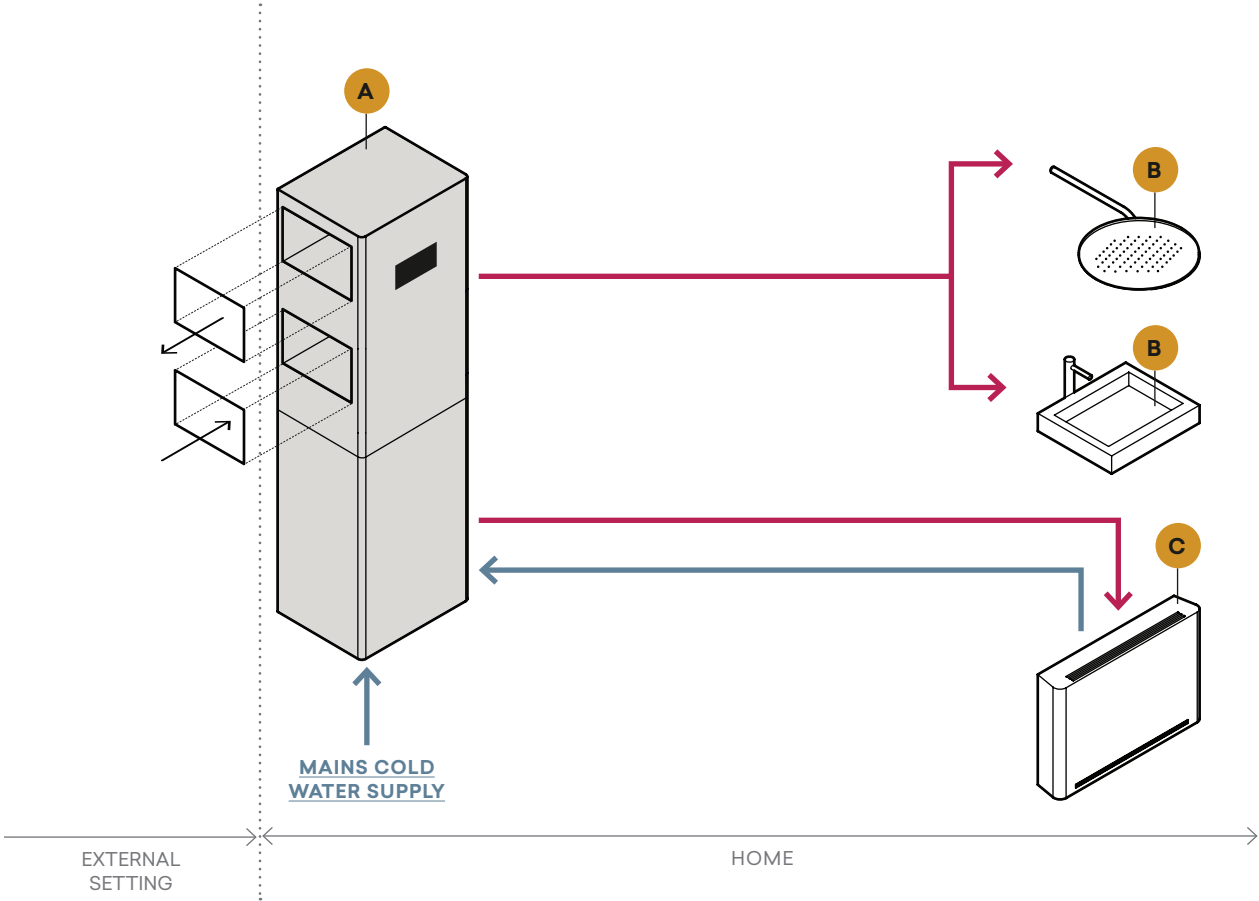

- A. 3in1 Mono indoor unit
 - B. Domestic hot water supply
 - C. Heating and/or cooling system
- Domestic hot water
— Cold water

Installation Options

Installation with rectangular duct

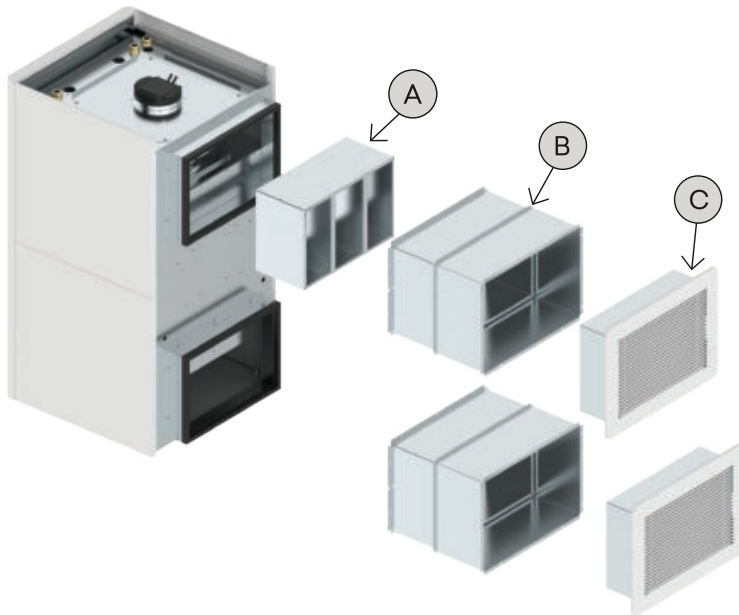

- (A) APDC0012II**
Silencer module
(bxhxp): 440x292x199 mm
- (B) APDC001III**
Telescopic duct
Length from 200 mm to 400 mm
Machine side (bxh): 460x313 mm
Sternal side (bxh): 470x353 mm
- (C) APDC0014II**
Kit no. 2 aesthetic grills
built-in with plenum
Recessed part: 460x313x120 mm
Grid: 542x400x16 mm
(laying on external side)

Installation with circular duct

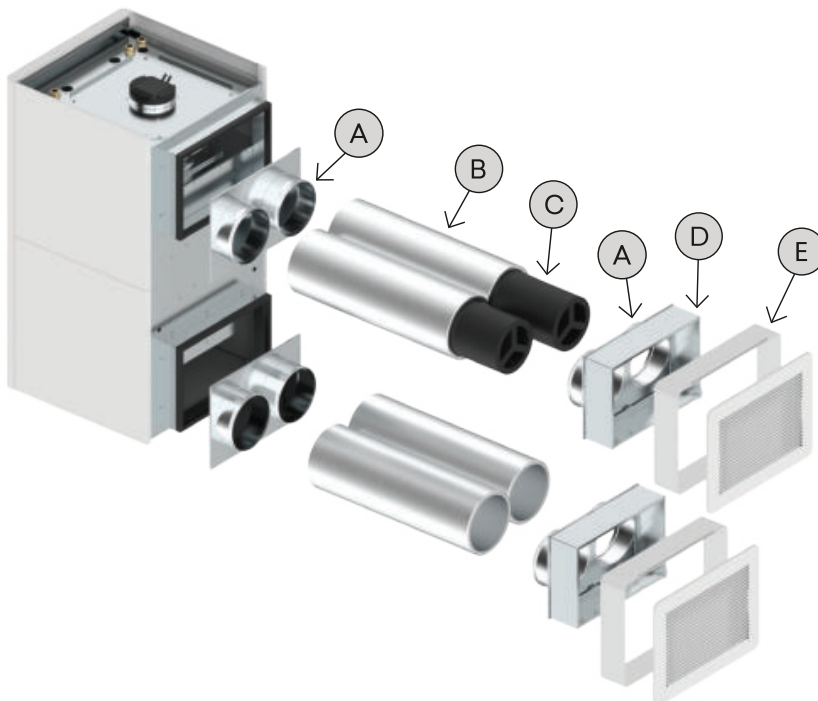

- (A) APDC0013II**
Kit no. 4 rectangular/circular air
intake and outlet plenum
DN 200 mm - male connection
dimensions: 467x320x87,5 mm
(laying on external side)
- (B) SCE200001II**
Ducting pipe
DN 200 mm
- (C) AHRC0038II**
Kit n.2 silencers
DN 200 mm
Length 480 mm
- (D) APDC0014II**
Aesthetic grill
built-in with plenum
Built-in part (bxhxp): 460x313x120 mm
Grill (bxhxp): 542x400x16 mm
- (E) APDC0015II**
Aesthetic frame
for installation of
visible aesthetic grill
dimensions (bxhxp): 542x400x109 mm



Configuration flexibility

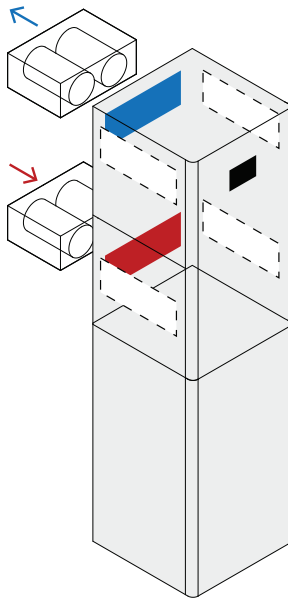

- Air outlet
- Air intake
- - - Alternative configurations

Possibility of airflow configuration on three sides during installation.
As standard, the unit is set up for air intake and supply on the back.

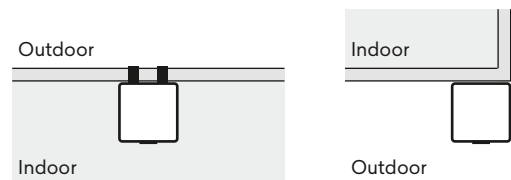

Dimensions

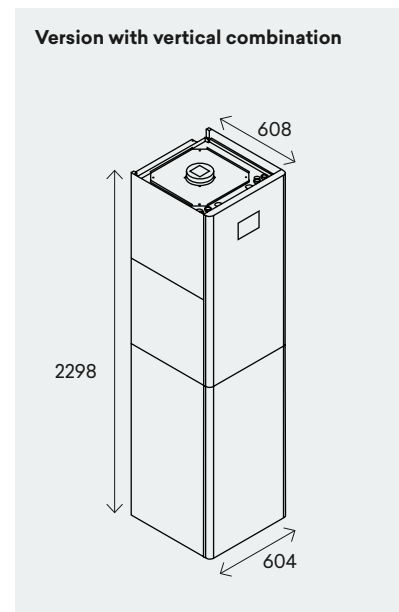
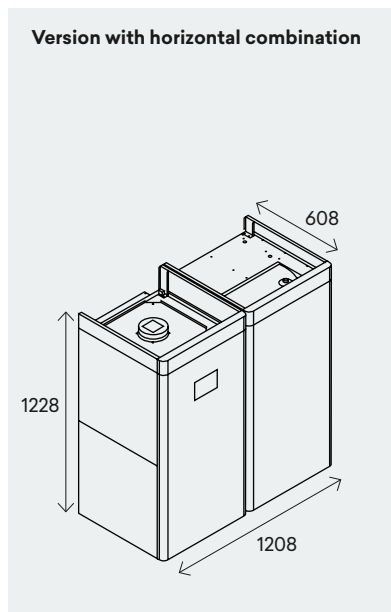
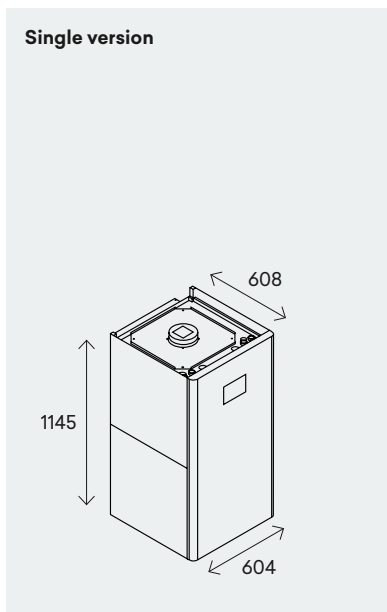

eHPoca



DC INVERTER

Maximum comfort with the lowest consumption and quietest operation



HIGH POWER RANGE

Power range up to 31 kW



APP

Remote control via App



ENERGY CLASS

Maximum A+++ energy class



eHPoca unit diagram

1. Automatic vent valve
2. Electrical heater (optional)
3. Plate heat exchanger
4. Differential pressure switch
5. Refrigeration connections
6. Return system hydraulic connection
7. Supply system hydraulic connection
8. Primary circulation pump PP1
9. Pressure gauge
10. Safety valve 3 bar
11. Expansion vesse

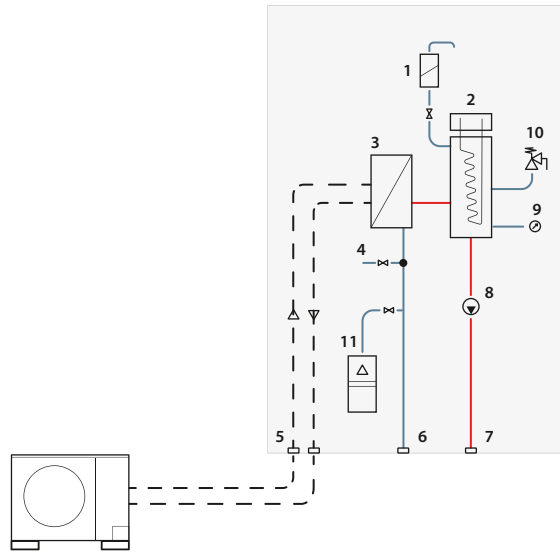

Standard components

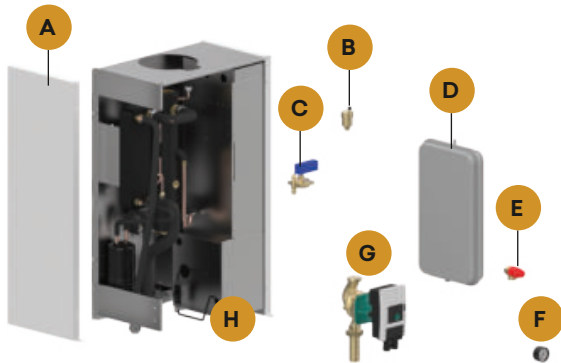

Standard components

- A. Structure, RAL9003 cover panels and display
- B. Automatic vent valve
- C. Differential pressure switch
- D. Expansion vessel
- E. Safety valve 3 bar
- F. Pressure gauge
- G. Primary circuit circulation pump
- H. Electrical box

Accessories kit (supplied installed in the unit)

- I. 6 kW heating element kit (3 steps of 2 kW). Factory setting 2 kW for single-phase heat pumps
- J. BUTLER PRO

Accessories kit (supplied separately)

- K. ACS 3-way valve
- L. ACS preparation tank
- M. Inertial DHW tank

Accessories kit (supplied installed in the unit)

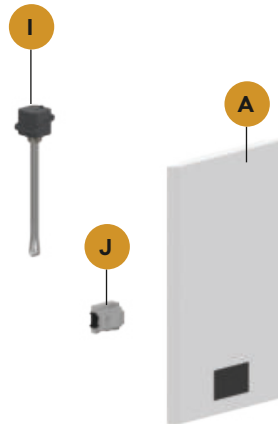

Accessories kit (supplied separately)

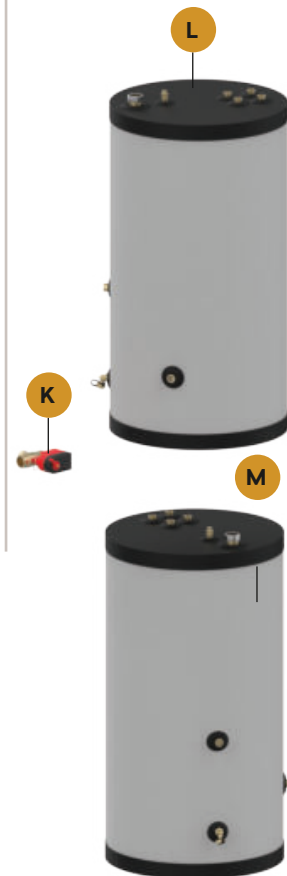

eHPoca installation

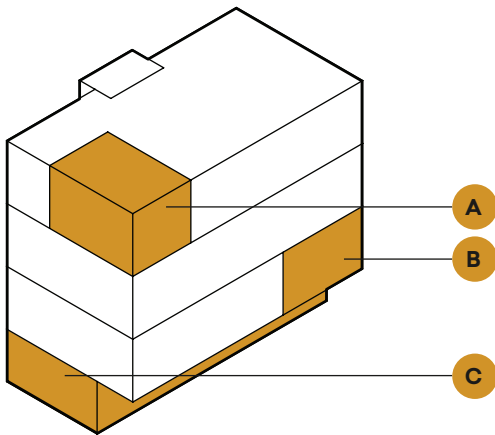

- A. Attic
- B. Laundry
- C. Cellar

eHPoca is a flexible solution.

Suitable accessories are supplied based on the application. For large homes or apartment blocks, for example, the DHW requirement may be met by choosing the appropriate DHW tank capacity of between 200 and 2000 litres.



Offices



Medium and large-sized homes



Centralised systems

eHPoca is a heat pump which can be modular and used in sequence to meet high power requirements. The indoor unit must be installed indoors in a suitable room to house all the system components.

Example of centralised system

- 1. eHPoca indoor unit
- 2. Domestic hot water tank
- 3. Outdoor unit
- 4. Refrigerant pipes
- 5. Domestic hot water / heating

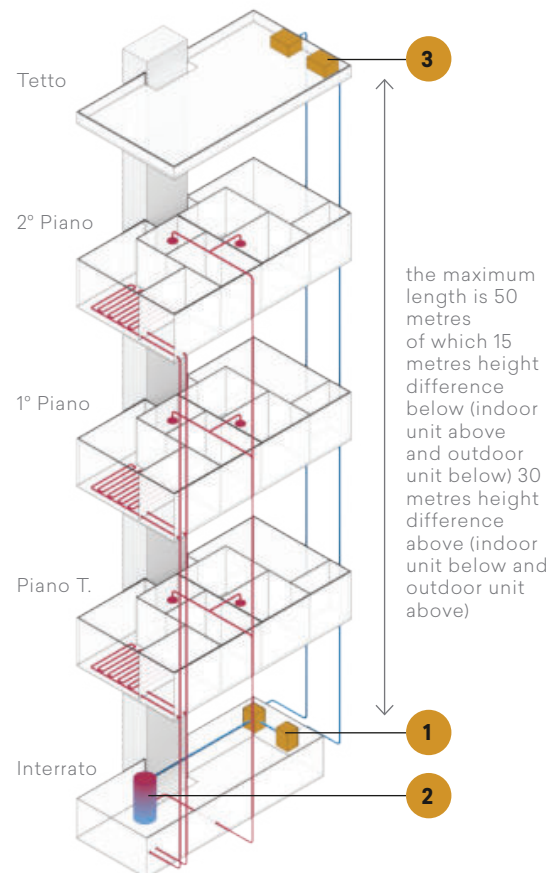

eHPoca system diagram

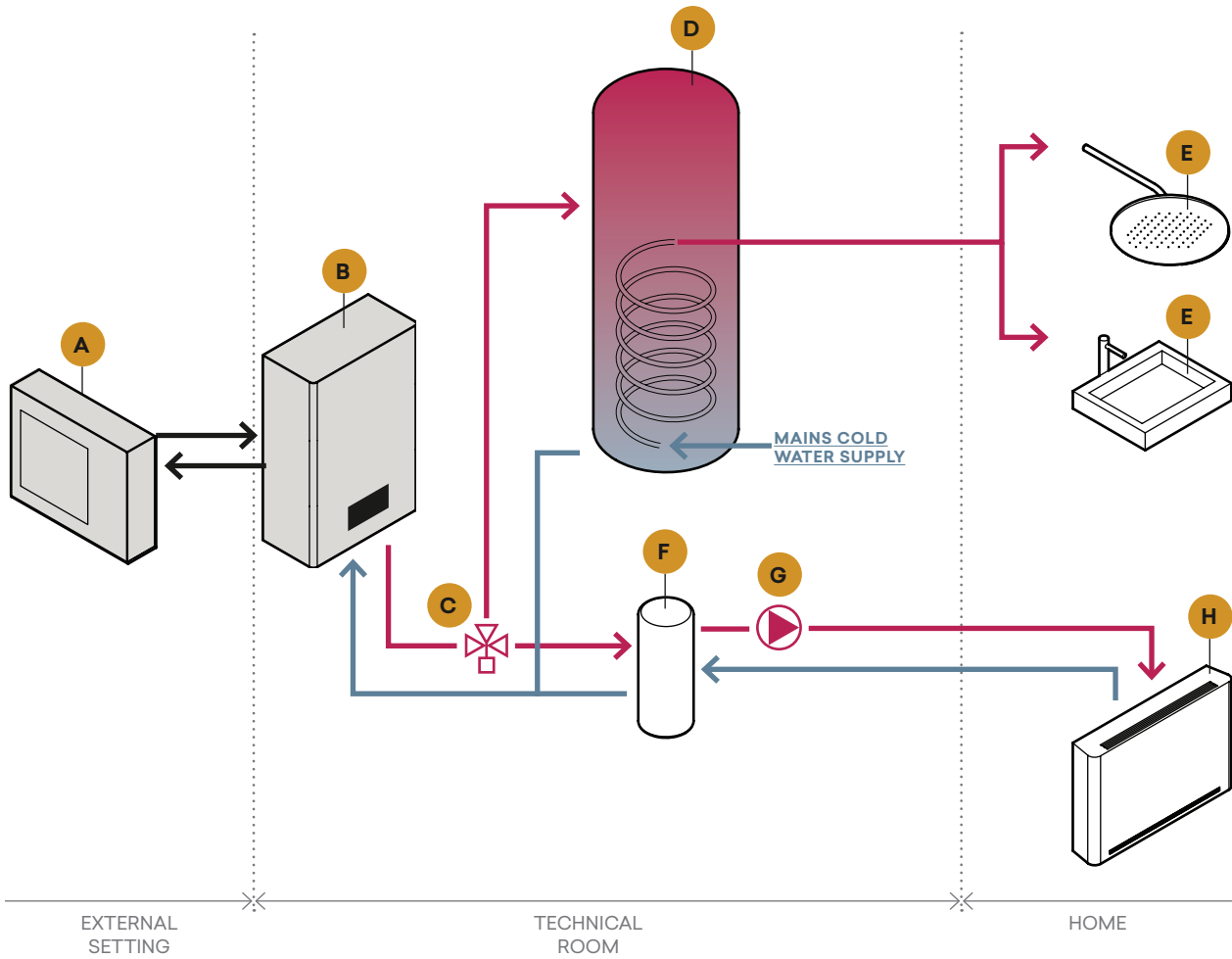

- A. Outdoor unit
- B. eHPoca indoor unit
- C. 3-way valve
- D. Thermal storage tank for instant preparation of DHW
- E. Domestic hot water supply

- F. Hydraulic separator
- G. Secondary circuit pump
- H. Heating and cooling system

- Domestic hot water
- Cold water

Installation distances

Front side completely free

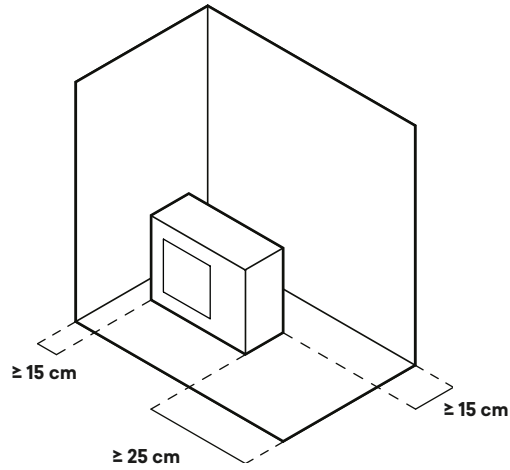

Rear side free

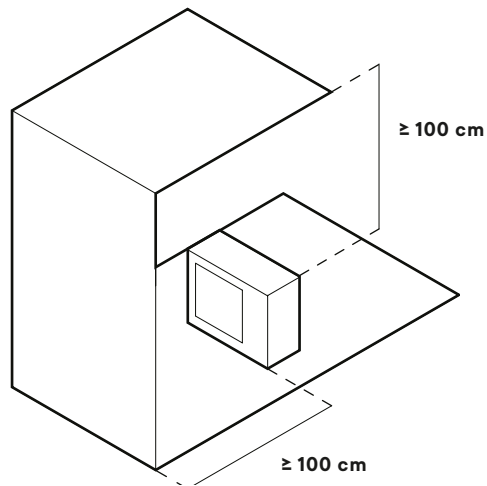

Left and right sides free

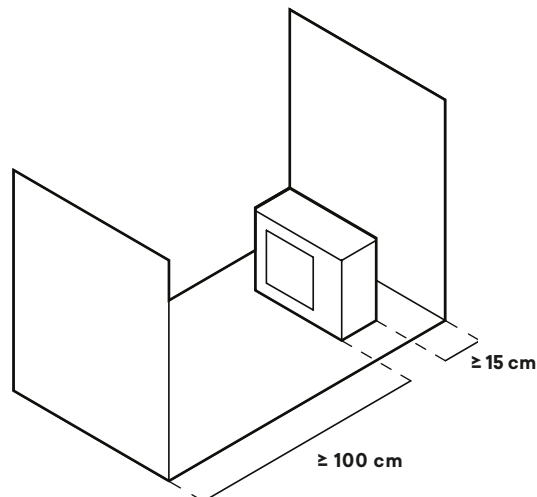

Distances between components

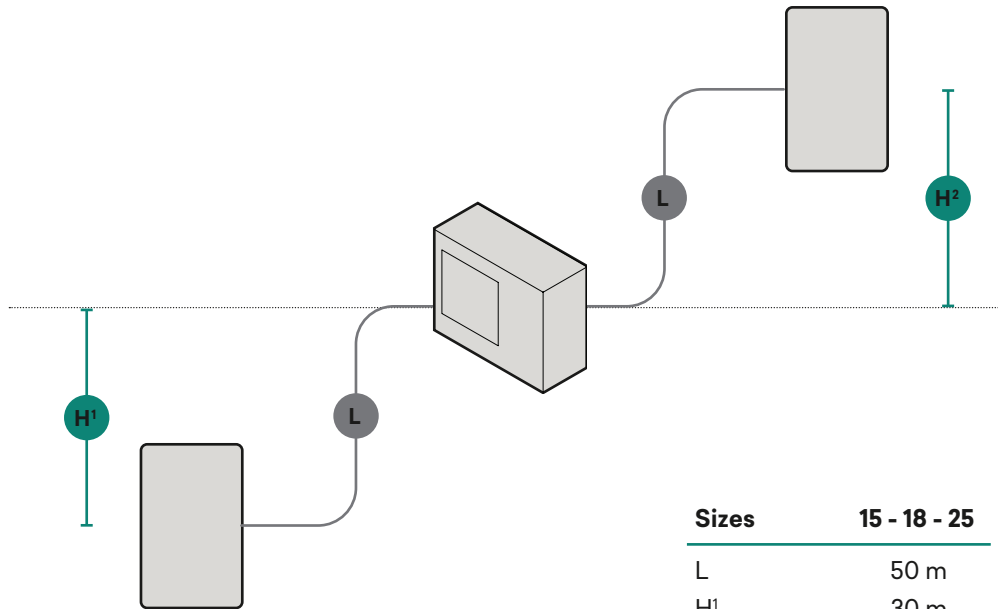

Sizes	15 - 18 - 25
L	50 m
H ¹	30 m
H ²	15 m

Outdoor units

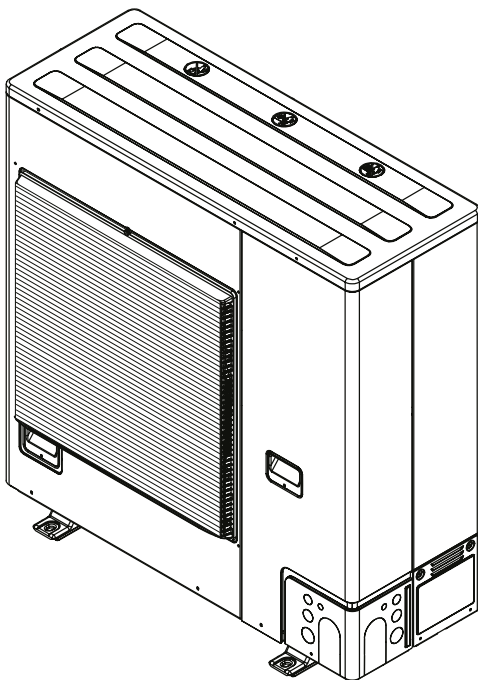

Single-fan unit

15 - 18 - 25

MODEL		15	18	25
L	mm	980	980	1140
P	mm	996	996	996
H	mm	370	370	460
Weight	kg	86	84	109

Domestic hot water

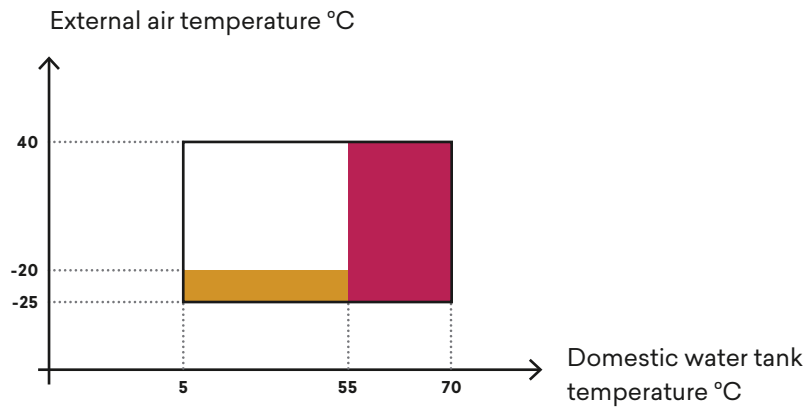

Heat pump off.
Heating by heating element,
boiler or solar integration

Integration by heating
element or boiler

Note: The areas represented by the diagram in the integration part are simplified. They may be more advantageous (greater contribution of the heat pump) in relation to operating conditions and internal operating parameters.

Note: For outdoor air temperatures below -15 °C, the unit may reduce the water temperature at the condenser output.

Cooling

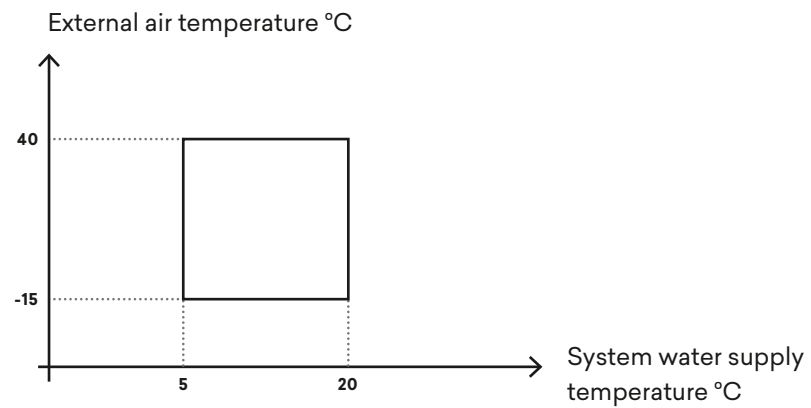

Note: The area shown in the diagram is simplified. It may be more advantageous in relation to outdoor operating conditions.



Heating

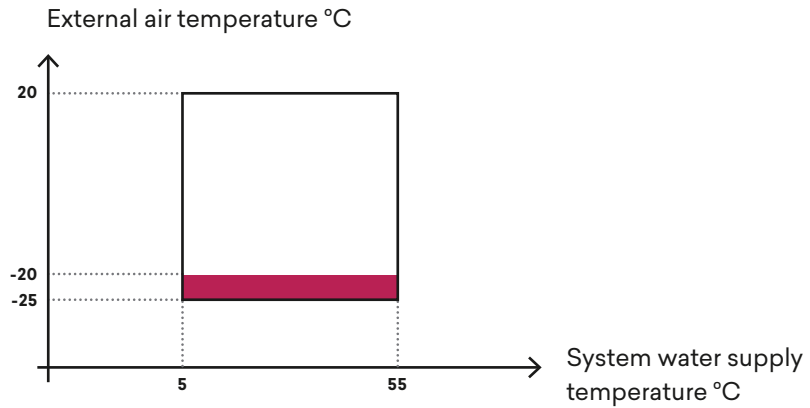

■ Integration by heating element or boiler

Note: The areas represented by the diagram in the integration part are simplified. They may be more advantageous (greater contribution of the heat pump) in relation to operating conditions and internal operating parameters.

Note: For outdoor air temperatures below -15°C , the unit may reduce the water temperature at the condenser output.

Benefits



DC Inverter compressor with wide modulation range.



Quiet unit due to continuous modulation of the fan with DC Inverter motor.

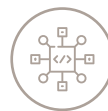

Advanced frost prevention algorithms for the finned coil.



Finned coil with hydrophilic treatment and sub-cooling circuit.

Technical data sheets

TECHNICAL SPECIFICATIONS		FULDA M1 - H1							
	u.m.	5M	7M	9M	9T	12M	12T	15M	15T
HEATING PERFORMANCE (A 7 °C BS; W 35 °C)									
Maximum heat output (1)	kW	7,61	9,43	12,52	12,52	17,19	17,19	19,21	19,21
Rated heat output (1)	kW	5,11	6,68	8,71	8,71	11,83	11,83	14,45	14,45
Total power input (1)	kW	0,98	1,47	1,71	1,71	2,35	2,35	3,13	3,13
COP (1)		5,23	4,55	5,09	5,09	5,03	5,03	4,61	4,61
P Design	kW	4,85	6,00	7,50	7,50	10,00	10,00	11,20	11,20
SCOP (1)		5,03	4,70	5,20	5,20	5,06	5,06	5,08	5,08
Energy efficiency class		A+++							
HEATING PERFORMANCE (A 7 °C BS; W 55 °C)									
Rated heat output (2)	kW	4,79	6,74	9,05	9,05	11,94	11,94	14,57	14,57
Total power input (2)	kW	1,50	2,22	2,96	2,96	3,74	3,74	4,78	4,78
COP (2)		3,20	3,03	3,06	3,06	3,19	3,19	3,05	3,05
P Design	kW	4,85	6,00	7,50	7,50	10,00	10,00	11,20	11,20
SCOP (2)		3,41	3,36	3,61	3,61	3,77	3,77	3,76	3,76
Energy efficiency class		A++							
HEATING PERFORMANCE (A-7 °C BS; W 35 °C)									
Maximum heat output (3)	kW	5,13	5,75	8,23	8,23	11,09	11,09	11,71	11,71
Rated heat output (3)		4,75	4,94	7,45	7,45	9,23	9,23	10,33	10,33
Total power input (3)	kW	1,69	1,81	2,71	2,71	3,11	3,11	3,65	3,65
COP (3)		2,81	2,73	2,75	2,75	2,96	2,96	2,83	2,83
COOLING PERFORMANCE (A35 °C; W 18 °C)									
Maximum cooling capacity (4)	kW	6,98	9,31	11,76	11,76	15,73	15,73	16,55	16,55
Rated cooling capacity (4)	kW	3,83	5,27	7,09	7,09	8,999	8,99	10,56	10,56
Total power input (4)	kW	0,65	1,04	1,29	1,29	1,72	1,72	2,20	2,20
EER (4)		5,92	5,09	5,50	5,50	5,23	5,23	4,79	4,79
P Design	kW	3,80	5,25	7,00	7,00	9,50	9,50	11,00	11,00
SEER (4)		9,07	7,69	8,66	8,66	8,11	8,11	7,59	7,59
Energy efficiency class		A+++	A++	A+++	A+++	A++	A++	A++	A++
COOLING PERFORMANCE (A35 °C; W 7 °C)									
Maximum cooling capacity (5)	kW	6,34	8,55	10,42	10,42	12,89	12,89	13,51	13,51
Rated cooling capacity (5)	kW	3,74	5,35	6,77	6,77	8,91	8,91	10,87	10,87
Total power input (5)	kW	1,02	1,73	1,92	1,92	2,78	2,78	3,58	3,58
EER (5)		3,66	3,09	3,52	3,52	3,20	3,20	3,04	3,04
P Design	kW	3,75	5,35	6,60	6,60	9,00	9,00	11,00	11,00
SEER (5)		5,55	5,32	5,64	5,64	5,13	5,13	5,19	5,19
HYDRAULIC SPECIFICATIONS									
Rated flow rate in heating	L/min	14,8	20,5	25,3	25,3	34,0	34,0	41,0	41,0
Rated flow rate in cooling	L/min	11,0	15,5	19,5	19,5	26,7	26,7	33,7	33,7
Useful head of primary circuit	kPa	110	110	105	105	100	100	90	90



TECHNICAL SPECIFICATIONS		FULDA M1 - H1							
		u.m.	5M	7M	9M	9T	12M	12T	15M
Hydraulic connection diameter	"GAS	1							
Minimum plant water content	L	21,46	28,06	36,58	36,58	49,69	49,69	60,69	60,69

REFRIGERATOR CONNECTIONS

Compressor	Twin Rotary DC Inverter								
Refrigerant type	R290								
Refrigerant quantity	kg	0,60	0,60	1,00	1,00	1,45	1,45	1,45	1,45

SOUND SPECIFICATIONS

Outdoor unit sound pressure in cooling and heating (6)	dB(A)	47	49	49	49	51	51	53	53
Outdoor unit sound pressure in cooling and heating 50% of load (7)	dB(A)	43	44	44	44	46	46	48	48
Outdoor unit sound power in cooling and heating (8)	dB(A)	55	57	57	57	59	59	61	61
Outdoor unit sound power in cooling and heating 50% load (9)	dB(A)	51	52	52	52	54	54	56	56

ELECTRICAL DATA

Voltage	V/ph/Hz	230/1/50	230/1/50	230/1/50	400/3/50	230/1/50	400/3/50	230/1/50	400/3/50
Maximum power consumption	kW	3,00	3,50	4,50	4,50	5,00	5,00	5,50	5,50
Maximum absorbed current	A	13,30	15,60	20,30	6,84	22,60	7,50	24,90	8,30
Indoor unit protection rating	IPX2								
Outdoor unit protection rating	IPX4								

DIMENSIONS AND WEIGHTS FULDA M1

Width	mm	915	915	1205	1205	1205	1205	1205	1205
Height	mm	730	730	904	904	1240	1240	1240	1240
Depth	mm	430	430	455	455	455	455	455	455
Weight	kg	67,3	69,0	101,0	101,0	130,0	131,0	130,0	131,0

(1) Water temperature in/out 30/35 °C; Outside air temperature 7 °C; U.R. 85%

(2) Water temperature in/out 50/55 °C; Outside air temperature 7 °C

(3) Water temperature in/out 30/35 °C; Outside air temperature -7 °C

(4) Water temperature in/out 23/18 °C; Outside air temperature 35 °C (radiant application)

(5) Water temperature in/out 12/7 °C; Outside air temperature 35 °C (fancoil application)

(6) Sound pressure at a distance of 1 meter in open field at the maximum power measured according to ISO 3745

(7) Sound pressure at a distance of 1 meter in open field with compressor modulating at 50% load measured according to ISO 3745

(8) Sound power at the maximum measured power according to EN 12102

(9) Sound power with modulating compressor at 50% load measured according to EN 12102

FULDA H1 dimensions

u.m.		00-SINGLE-PHASE	00-THREE-PHASE
DIMENSIONS AND WEIGHTS			
Width	mm	600	600
Height	mm	2000	2000
Depth	mm	600	600
Weight	kg	152,0	152,0

Technical data sheets

TECHNICAL SPECIFICATIONS		3in1 Mono	
		5M	7M
	u.m.		
HEATING PERFORMANCE (A 7 °C BS; W 35 °C)			
Maximum heating capacity (1)	kW	7,50	9,04
Nominal heating capacity (1)	kW	4,51	5,59
Total absorbed power (1)	kW	1,02	1,28
COP (1)		4,46	4,41
SCOP (1)		4,21	4,13
Energy efficiency class		A++	
HEATING PERFORMANCE (A-7 °C BS; W 35 °C)			
Maximum heating capacity (2)	kW	5,16	6,24
Total absorbed power (2)	kW	1,76	2,40
COP (2)		2,93	2,70
COOLING PERFORMANCE (A35 °C; W 18 °C)			
Maximum cooling capacity (3)	kW	8,11	10,28
Nominal cooling capacity (3)	kW	5,53	6,56
Total absorbed power (3)	kW	1,38	1,67
EER (3)		4,01	3,93
SEER (3)		6,78	7,22
COOLING PERFORMANCE (A35 °C; W 7 °C)			
Maximum cooling capacity (4)	kW	6,25	7,83
Nominal cooling capacity (4)	kW	4,04	4,88
Total absorbed power (4)	kW	1,38	1,78
EER (4)		2,93	2,74
HYDRAULIC SPECIFICATIONS			
Nominal flow rate	L/min	15,0	21,0
Available pressure primary circuit	kPa	65,0	55,0
Hydraulic connection diameter	"GAS	1	1
Expansion tank capacity	L	4	4
Minimum system water content	L	20,0	25,0
DHW tank capacity	L	200	200
AERUALIC CONNECTIONS			
Fan type		Modulating	
Air flow rate at maximum speed	m³/h	1850	2200
Air flow rate at minimum speed	m³/h	750	900
Air flow rate at nominal speed	Pa	80	80
Maximum available static pressure (5)	Pa	200	200



TECHNICAL SPECIFICATIONS	u.m.	3in1 Mono	
		5M	7M
Wall-hole diameter	mm	200	200
Expulsion/immission	(bxh) mm	470 x 350	

REFRIGERATOR CONNECTIONS

Compressor		Twin Rotary DC Inverter	
Refrigerant		R32	
Refrigerant charge	kg	1,55	1,55

SOUND DATA

Rated sound pressure	dB(A)	47	49
----------------------	-------	----	----

ELECTRICAL DATA

Voltage	V/ph/Hz	230/1/50	230/1/50
Maximum power consumption	kW	3,80	4,10
Maximum current consumption	A	14,00	19,00
Maximum power consumption booster	kW	2,00	2,00
Maximum current consumption booster	A	8,60	8,60
Protection rating indoor unit		IPX2	

DIMENSIONS AND WEIGHTS SV UNIT - VERSION WITH HORIZONTAL COMBINATION

Width	mm	604	604
Height	mm	2298	2298
Depth	mm	608	608
Net weight	kg	240,0	240,0

DIMENSIONS AND WEIGHTS SH UNIT - VERSION WITH VERTICAL COMBINATION

Width	mm	1208	1208
Height	mm	1228	1228
Depth	mm	608	608
Net weight (7)	kg	125,0 / 115,0	125,0 / 115,0

DIMENSIONS AND WEIGHTS UNIT S - SINGLE VERSION

Width	mm	604	604
Height	mm	1145	1145
Depth	mm	608	608
Net weight	kg	125,0	125,0

- (1) Water temperature in/out 30/35 °C; Outside air temperature 7 °C; U.R. 85%
- (2) Water temperature in/out 30/35 °C; Outside air temperature -7 °C
- (3) Water temperature in/out 23/18 °C; Outside air temperature 35 °C (radiant application)
- (4) Water temperature in/out 12/7 °C; Outside air temperature 35 °C (fancoil application)
- (5) To be set at startup
- (6) Sound pressure at a distance of 1 meter measured in a semi-anechoic chamber according to UNI EN 3744
- (7) Weights refer to separate heat pump/DHW module

Technical data sheets

TECHNICAL SPECIFICATIONS		eHPoca		
		15 M/T	18 T	25 T
	u.m.			
HEATING PERFORMANCE (A 7 °C BS; W 35 °C)				
Maximum heating capacity (1)	kW	22,80	26,90	31,07
Nominal heating capacity (1)	kW	14,61	15,95	24,78
Total absorbed power (1)	kW	2,95	3,69	5,87
COP (1)		4,95	4,32	4,22
SCOP (1) (2)		4,92	4,45	4,11
ENERGY EFFICIENCY				
Energy efficiency class (3)		A+++		
HEATING PERFORMANCE (A-7 °C BS; W 35 °C)				
Maximum heating capacity (4)	kW	14,74	17,36	18,37
Total absorbed power (4)	kW	2,87	3,54	5,12
COP (4)		3,15	2,83	2,86
COOLING PERFORMANCE (A35 °C; W 18 °C)				
Maximum cooling capacity (5)	kW	18,56	23,15	32,64
Nominal cooling capacity (5)	kW	15,60	19,40	27,94
Total absorbed power (5)	kW	3,90	4,70	6,65
EER (5)		4,00	4,13	4,20
SEER (5)		6,62	7,23	7,10
COOLING PERFORMANCE (A35 °C; W 7 °C)				
Maximum cooling capacity (6)	kW	13,34	16,45	23,24
Nominal cooling capacity (6)	kW	11,20	13,90	19,90
Total absorbed power (6)	kW	3,50	4,40	6,31
EER		3,20	3,19	3,15
SEER (6)		5,12	5,95	5,81
HYDRAULIC DATA				
Nominal flow rate in heating	L/min	41,9	45,7	71,0
Nominal flow rate in cooling	L/min	44,7	55,5	80,1
Available pressure primary circuit	kPa	31,0	51,0	40,0
Hydraulic connection diameter	"GAS		1	
Expansion tank capacity	L	8	8	8
Minimum system water content	L	65,0	75,0	110,0



TECHNICAL SPECIFICATIONS		eHPoca		
		u.m.	15 M/T	18 T
REFRIGERATOR CONNECTIONS				
Refrigerant type			R32	
Refrigerant quantity	kg	3,05	3,05	3,50
Extraction	" SAE	5/8	5/8	7/8 a saldare
Extraction	" SAE	3/8	3/8	1/2
SOUND DATA				
Sound pressure indoor unit (7)	dB(A)	31,0	32,0	32,0
Sound pressure of outdoor unit Heating (8)	dB(A)	53	54	57
Sound pressure of outdoor unit Cooling (8)	dB(A)	53	55	58
ELECTRICAL DATA				
Voltage	V/ph/Hz	230/1/50 - 400/3/50	400/3/50	400/3/50
Protection rating indoor unit			IPX2	
Protection rating outdoor unit			IPX4	
DIMENSIONS AND WEIGHT				
Width	mm	501	501	501
Height	mm	826	826	826
Depth	mm	321	321	321
Empty weight	kg	43,0	43,0	46,00
DIMENSIONS AND WEIGHT (EXTERNAL UNIT)				
Width	mm	980	980	1140
Height	mm	996	996	996
Depth	mm	370	370	460
Empty weight	kg	86,0	84,0	109,0

- (1) Water temperature in/out 30/35 °C; Outside air temperature 7 °C; U.R. 85%
- (2) Value referred to the Average climate profile for flow temperature of 35 °C. Values in accordance with Regulation 811/2013.
- (3) Seasonal efficiency according to UNI EN 14825. Energy Efficiency Class referred to the Average climate profile for flow temperature of 35 °C in accordance with Regulation 811/2013
- (4) Water temperature in/out 30/35 °C; Outside air temperature -7 °C
- (5) Water temperature in/out 23/18 °C; Outside air temperature 35 °C (radiant application)
- (6) Water temperature in/out 12/7 °C; Outside air temperature 35 °C (fancoil application)
- (7) Sound pressure at a distance of 1 meter measured in an anechoic chamber according to UNI EN 3744
- (8) Sound pressure at a distance of 1 meter in open field at the maximum power measured according to ISO 3745

BUTLER^{PRO}, smart system control

BUTLER^{PRO} web server is the system developed by INNOVA to manage an entire heating and cooling system directly in your home or remotely. BUTLER^{PRO} allows you to connect the heat pump, controlled mechanical ventilation system, fan coils and all the other system elements via a serial connection.

BUTLER^{PRO} is complete, simple and intuitive at the same time. You can configure a weekly calendar with time zones, create specific zones and change the settings so your home is at the right comfort level for your needs.

TWO VERSIONS

BUTLER^{PRO}

settings and visualisation via smartphone / tablet / computer only with internet connection.

Installation on 35 mm DIN rail in the heat pump's electrical box or in the house electrical box.



BUTLER^{PRO TOUCH}
with built-in display



Display



BUTLER^{PRO}
via WEB



Local PC

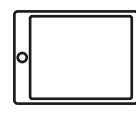

Mobile o tablet

BUTLER^{PRO TOUCH}

settings and visualisation via the built-in 10" touch screen display. Remotely connectable to the internet via smartphone/tablet/computer. Built-in wall installation. Pre-installation box is supplied separately.

ROOM BY ROOM CONTROL

You can control each room with BUTLER^{PRO} by configuring a weekly calendar with time zones, creating settings for each room or area, modifying the settings so your home is at just the right comfort level for your needs.

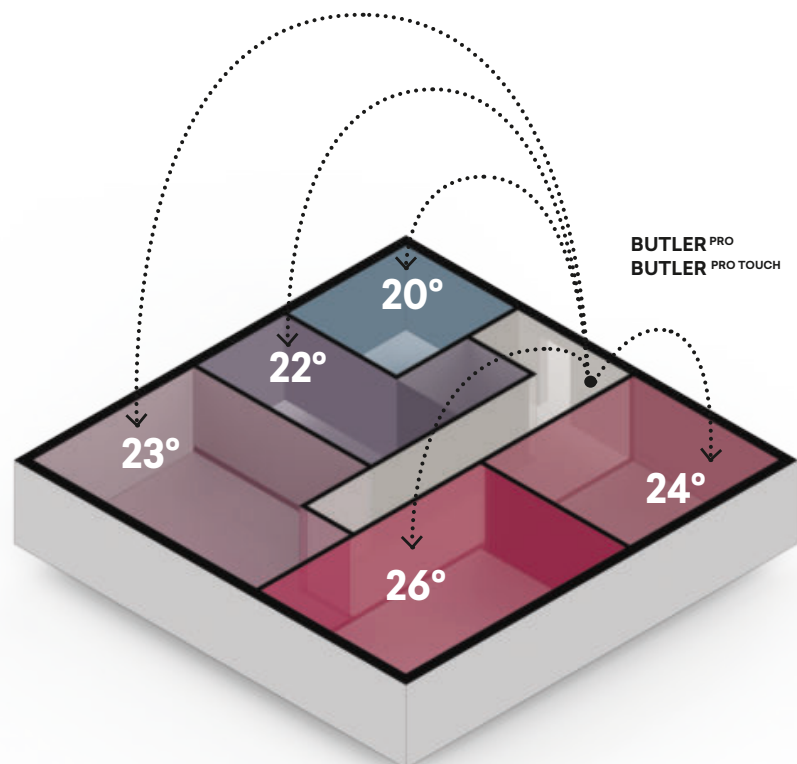

MAIN FUNCTIONS

- **Monitoring and control in local network or remotely**

The system can be managed by any smartphone, tablet or computer

- **Personalised winter and summer programming**

You can have different programmes for every season

- **Three temperature level setting on INNOVA fan coil network**

For each room or area, you can select 3 different operating temperatures, which can be modified at any time

- **Weekly programming schedule**

You can set the schedule for the different functions for each room; the same can be done for HRV and fan coils

- **PC-type network interface**

Once the bus network has been set up between the heat pump and the fan coils, the connection to the web server is the same as a standard computer

- **Remote assistance**

With the consent of the user, BUTLER can automatically enter the INNOVA cloud for diagnostics and assistance if it is needed

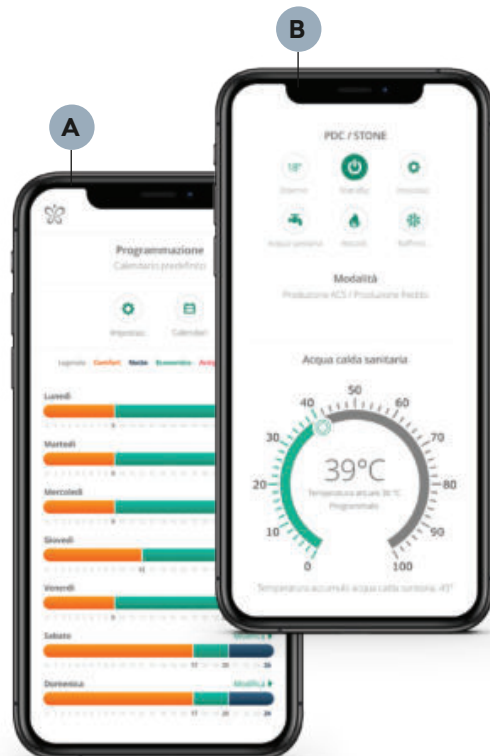

A WEEKLY SCHEDULING

B DOMESTIC HOT WATER SETTINGS



Remote assistance

With the consent of the user, BUTLER^{PRO}, can automatically enter the INNOVA cloud for diagnostics and assistance, if needed.

Thanks to the internet connection, it is possible to check if the INNOVA products connected to the BUTLER^{PRO} are working correctly. Any malfunctions can be automatically sent to the BUTLER^{PRO} at the support centre which can intervene by modifying the operating parameters or deciding to intervene directly, thus providing a fast and prompt service.

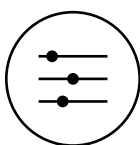
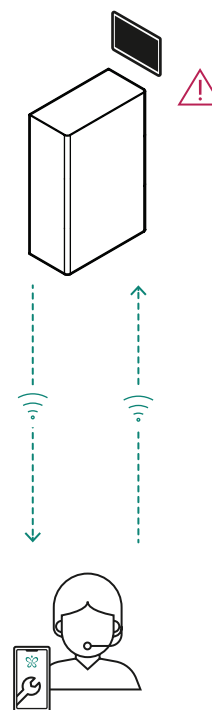

Total control

The advantage of choosing a complete INNOVA system is that we are your sole contact point for any requirement, both for programmed maintenance and support. A complete, quality service.



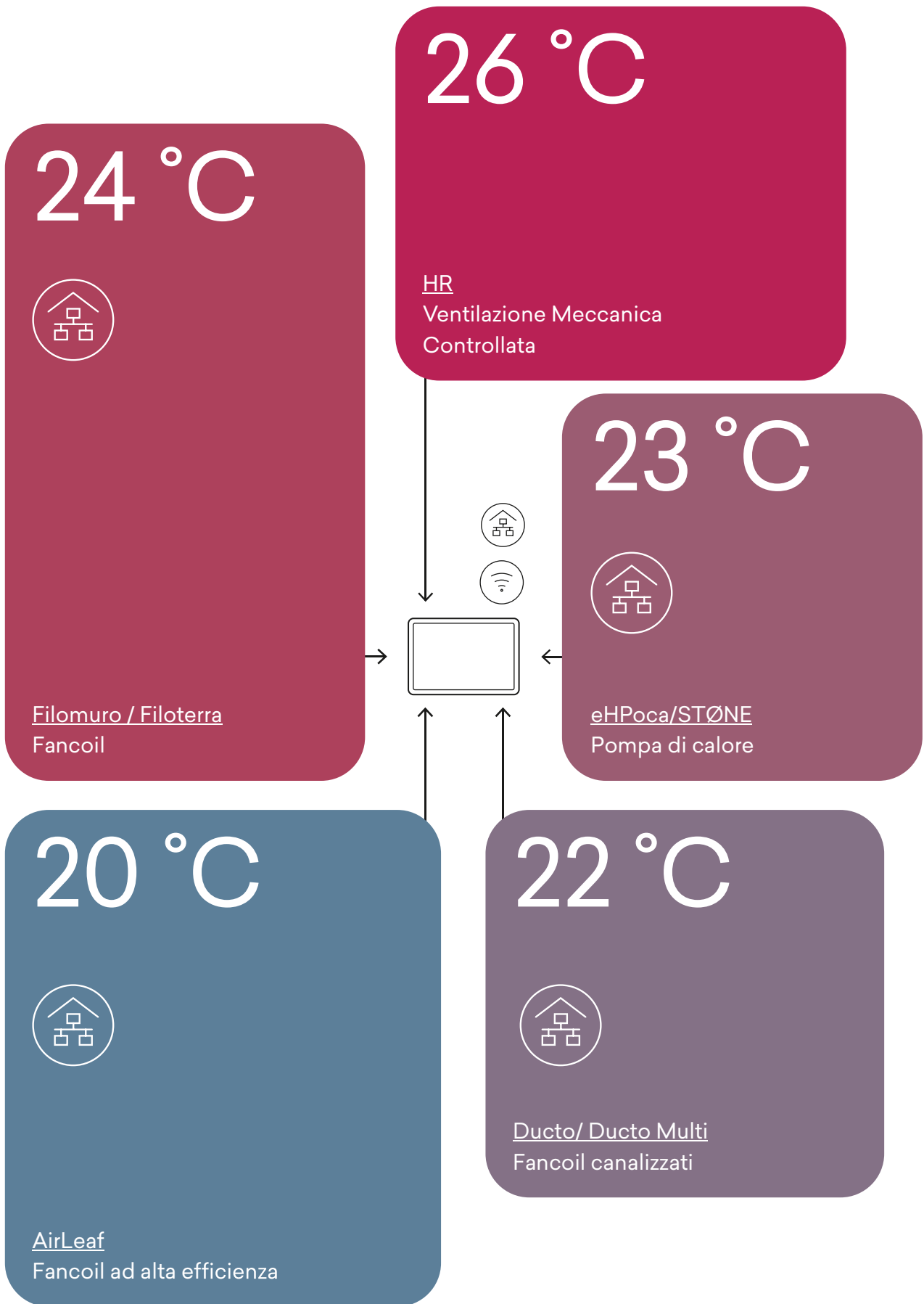

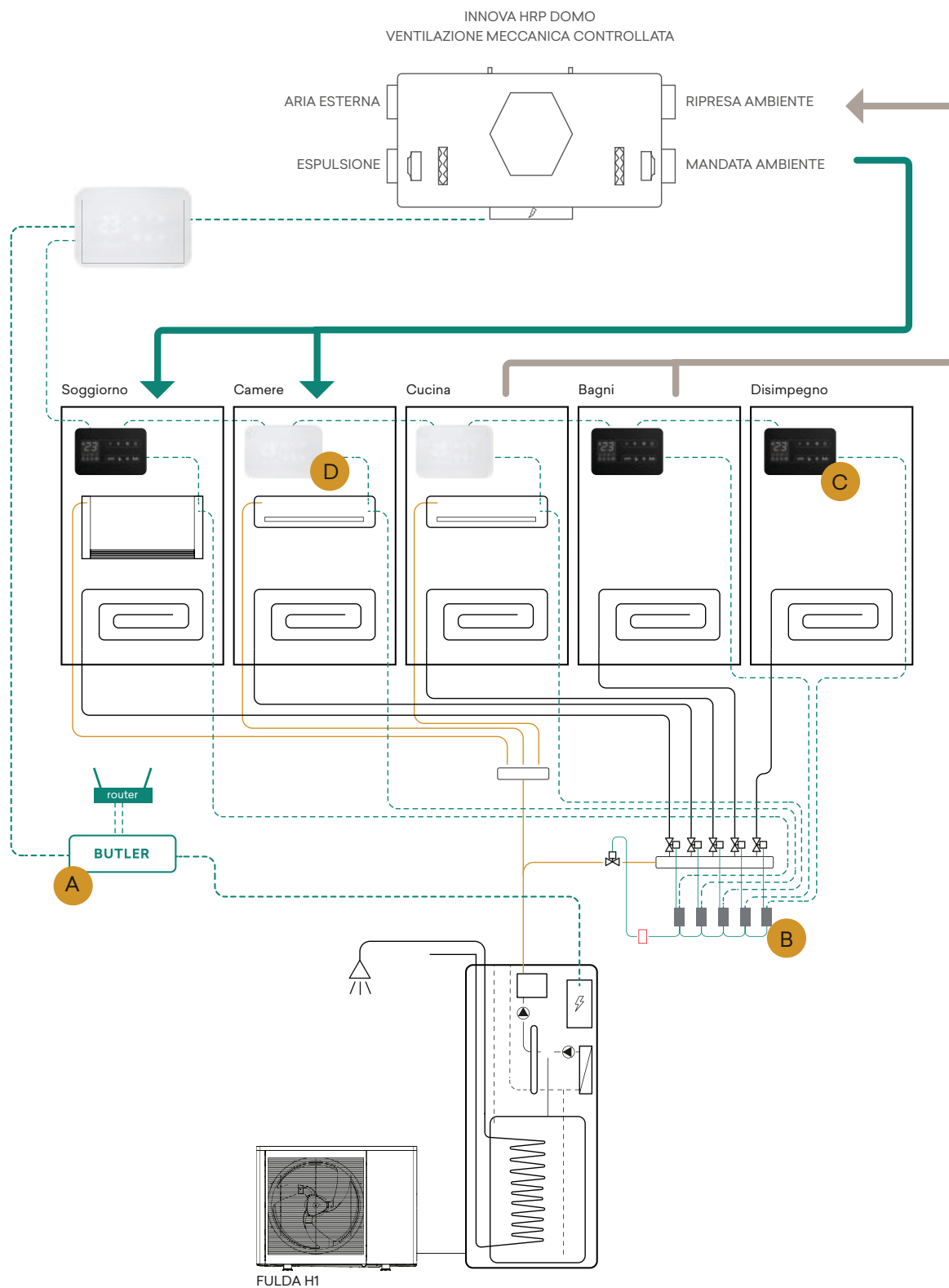

- A. BUTLER PRO TOUCH
- B. MZS - Modulo di zona singolo
- C. Termostato serie SMART TOUCH
- D. Termostato serie M7



What is a Heat Pump?



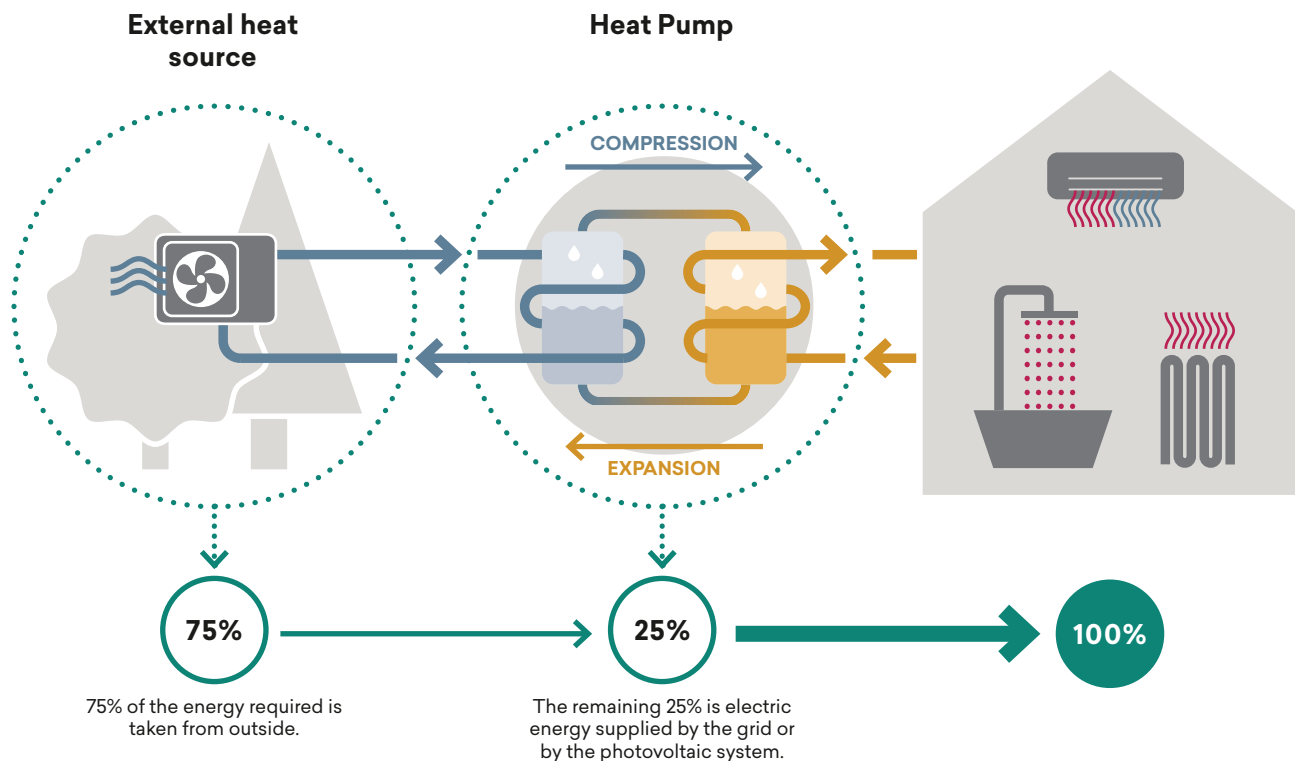

A heat pump is a unit used to heat, cool and produce domestic hot water. The way it works is similar to a fridge: the heat taken from a low-temperature environment is transferred to a higher-temperature one.

So, the heat pump takes heat from a cold outside area and transfers it to another, warmer, indoor area. By inverting the operating cycle, it is possible to cool rooms in summer: with the same principle: the heat extracted from the indoor space is taken outside.

This process uses thermal energy already present in nature (air, water or, in the case of geothermal, the ground). Heat pumps are extremely efficient heat generators that use renewable and free energy.



Comparison between a gas boiler and a Heat Pump*

	ENERGY REQUIRED	ENERGY PRODUCED BY A GAS BOILER	ENERGY PRODUCED BY A HEAT PUMP	
 HEATING	10 kWh	1,75 €	1,00 €	-43 %
 DOMESTIC HOT WATER (DHW)	1,3 ^{**} kWh	0,22 €	0,13 €	-40 %
 RENEWABLE ENERGY		0	5,5 kWh	100 %
 EMISSIONS		2,68 kg CO ₂	1,25 kg ^{***} CO ₂	-50 %

* Considerations with high-efficiency boiler and natural gas cost 1.2 €/m³ - electricity 0.4 €/kWh

** Daily energy requirement of one individual = 50 litres of hot water at 40° C

*** CO₂ emissions indirectly produced by national power grid 1kWh = 0.4332 Kg CO₂





Efficiency of a Heat pump Inverter vs on/off

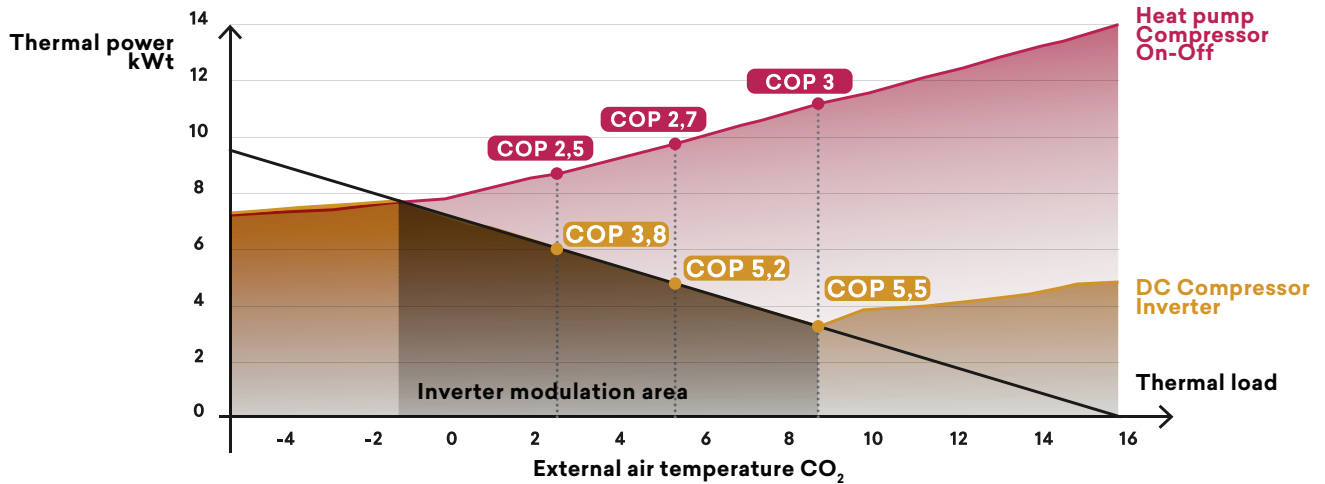

COP : Represents the power produced and the power absorbed

The requirement of a building is maximum at the design temperature and decreases linearly as the outside temperature increases. The heat pump with inverter compressor modulates the power supplied based on the building requirement. As the external temperature increases, the power supplied decreases and so, increases efficiency.

The heat pump with on/off compressor always works at 100% and, as the external temperature increases, the power generated increases, in contrast to the building requirement. In these conditions, in order to meet the requested load, the compressor works by repeatedly turning off and on which significantly reduces efficiency.



Energy savings

INNOVA DC Inverter heat pumps guarantee significant energy savings both in heating and in the production of domestic hot water thanks to the high levels of SCOP (seasonal coefficient of performance). Compared to a conventional heating system (e.g. boiler), the cost of energy, used for an entire winter, can be between 30% and 50% less.



heaters

dal 30% → al 50%



radiant panels



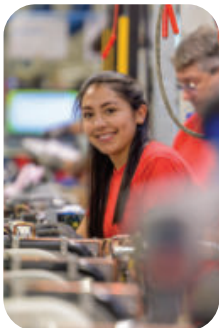
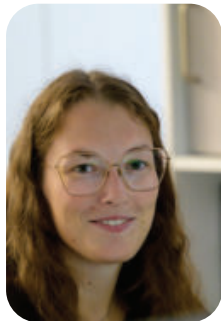
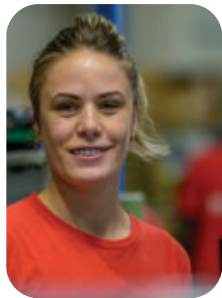
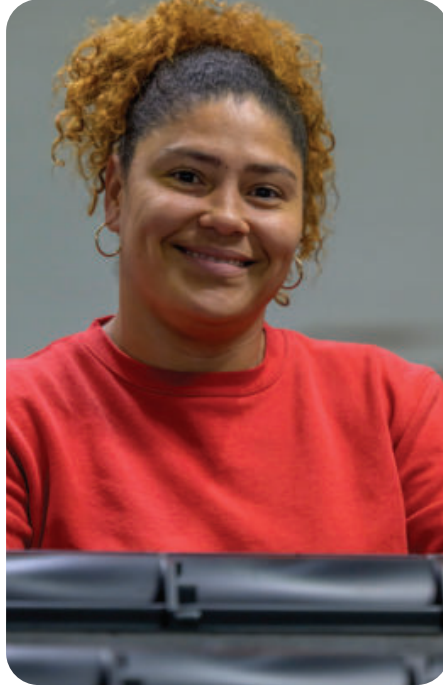

Ideas, products, people.

CREDITS

Product Designer

Luca Papini

Art Direction & Graphic

Osmo design

Photography

Ottavio Tomasini

Special thanks to:

Akira Nishikawa

© All rights reserved -
photographs, images and
texts are protected by
copyright, any use of all or
part of them not expressly
authorised by
INNOVA will result in
consequent sanctions.
INNOVA reserves the right
to make changes at any time
to its products, accessories
and technical data in order to
improve its offer.



